



**Notice of Intent (NOI) for Small Municipal
Separate Storm Sewer Systems (MS4) authorized
under TPDES Phase II MS4 General Permit
TXR040000**

IMPORTANT:

Use the [INSTRUCTIONS](#) to fill out each question in this form.

Once approved, your permit authorization can be viewed at:
<http://www.tceq.texas.gov/goto/wq-dpa>

APPLICATION FEE:

You must pay the **\$400** Application Fee to TCEQ for the application to be complete.
Payment and NOI must be mailed to separate addresses.

You can pay online at: <http://www.tceq.texas.gov/goto/epay>

Select Fee Type: GENERAL PERMIT MS4 PHASE II STORMWATER DISCHARGE NOI
APPLICATION

Provide your payment information below, for verification of payment:

Mailed Check/Money Order Number:

Check/Money Order Amount:

Name Printed on Check:

EPAY Voucher Number: 425790

Is a copy of the Payment Voucher enclosed? Yes

**One (1) copy of the NOI, Stormwater Management Program (SWMP) cover sheet,
and SWMP MUST be submitted with the original NOI, SWMP cover sheet, and
SWMP.**

Is the copy attached? Yes

REASON FOR APPLICATION:

Select the reason you are submitting this application:

New authorization

Renewal of authorization number: TXR040625

Note: An authorization cannot be renewed after July 23, 2019

Section 1. OPERATOR (Applicant)

- a) If the applicant is currently a customer with TCEQ, what is the Customer Number (CN) issued to this entity? CN 600916191
- b) What is the exact Legal Name of the entity (applicant) applying for this permit?
Fern Bluff Municipal Utility District
- c) Complete and attach a Core Data Form (TCEQ-10400) for this customer.

Section 2. ANNUAL BILLING CONTACT

The operator is responsible for paying the annual water quality fee. The annual fee will be assessed to permits active on September 1 of each year. TCEQ will send a bill to the address provided in this section. The operator is responsible for terminating the permit when it is no longer needed.

Provide the name and contact information of the billing contact.

Prefix (Mr. or Ms.): Mrs.

First and Last Name: Janey Miller

Title: General Manager

Organization Name: Fern Bluff Municipal Utility District

Phone Number: (512) 238-0606

Fax Number: (512) 238-7323

Email: gm@fernbluffmud.org

Mailing Address: 7320 Wyoming Springs Dr.

City, State, and Zip Code: Round Rock, TX 78681

Section 3. APPLICATION CONTACT

This is the person TCEQ will contact if additional information is needed about this application.

Provide the name and contact information of the application contact.

Prefix (Mr. or Ms.): Mrs.

First and Last Name: Janey Miller

Title: General Manager

Organization Name: Fern Bluff Municipal Utility District

Phone Number: (512) 238-0606

Fax Number: (512) 238-7323

Email: gm@fernbluffmud.org

Mailing Address: 7320 Wyoming Springs Dr.

City, State, and Zip Code: Round Rock, TX 78681

Section 4. REGULATED ENTITY (RE) INFORMATION FOR SITE

- a) If this is an existing permitted site, what is the Regulated Entity Number (RN) issued to this site? RN 105597561
- b) Name of site as known by the local community:
Fern Bluff MUD MS4
- c) Name of the urbanized area(s) the Phase II MS4 is located within:
City of Austin Urbanized Area
- d) Provide a brief description of the regulated MS4 boundaries: *Example: Area within the City of XXXX limits that is located within the xxx urbanized area:*
Area within the City of Round Rock ETJ and within the City of Austin Urbanized Area

Section 5. GENERAL CHARACTERISTICS

- a) Is this site located on Indian Country Lands?
- Yes, do not submit this form. You must obtain authorization through U.S. EPA Region 6.
- No, continue to item b
- b) Has TCEQ formally "designated" the small MS4 as needing coverage under this general permit?
- Yes. Attach a copy of the documentation sent to the MS4 by TCEQ.
- No
- c) Select the MS4 level, which is based on the population served within the urbanized area (UA) **based on the most recent Decennial Census at the time of issuance of the general permit.**
- Level 1:** Traditional small MS4s with a population of less than 10,000.
- Level 2:** Traditional small MS4s with a population of at least 10,000 but less than 40,000.
- Non-traditional MS4s: This level also includes all non-traditional small MS4s regardless of population unless the non-traditional MS4 can demonstrate that it meets the criteria for a waiver from permit coverage. *Examples of non-traditional small MS4s include counties, drainage districts, transportation entities, military bases, universities, colleges, correctional institutions, municipal utility districts, and other special districts.*
- Level 3:** Traditional small MS4s with a population of at least 40,000 but less than 100,000.
- Level 4:** Traditional small MS4s with a population of 100,000 or more.
- d) What is the estimated current population served by your MS4 (regulated area?)
5,700 People

e) Is the MS4 part of a coalition?

- Yes
- No

f) If yes, list the entity names of the coalition members responsible for implementation of the SWMP *and* their unique TXR04#### number.

- | | | |
|----|--------------|---|
| 1. | <u>TXR04</u> | - |
| 2. | <u>TXR04</u> | - |
| 3. | <u>TXR04</u> | - |
| 4. | <u>TXR04</u> | - |
| 5. | <u>TXR04</u> | - |
| 6. | <u>TXR04</u> | - |

If needed, add a copy of this page to add more entities.

g) What is your annual reporting year?

- Calendar year
- Small MS4 General Permit year
- MS4 Fiscal year - What is the last month and day of the fiscal year?

h) Stormwater Management Program (SWMP)

1. I certify that the SWMP submitted with this NOI has been developed according to the provisions of the Small MS4 General Permit TXR040000. Yes
2. I certify that the SWMP Cover Sheet is completed and attached to the front of the SWMP. Yes
3. Have the program elements in the previous SWMP been re-assessed and modified and new program elements been developed and implemented, as necessary?
 Yes
 No. This facility did not have a previous authorization.
4. Is the optional 7th Minimum Control Measure (MCM) for Municipal Construction Activities selected and included with the attached SWMP?
 No. Continue to Question 5.
 Yes.
If yes, is MCM 7 limited to the regulated area within the urbanized area?
 Yes. Continue to Question 5.
 No

If No, then MCM 7 is included in the geographic area or boundary outside of the urbanized area. Note: In this case, you must incorporate the entire area

(urbanized and non-urbanized areas) in the SWMP and implement all MCMs 1-7 in the urbanized and non-urbanized areas.

5. Provide the name and contact information of the person responsible for implementing or coordinating implementation of the SWMP.

Prefix (Mr. or Ms.): Mr.

First and Last Name: Hector Alanis

Title: Operations Manager

Organization Name: Fern Bluff Municipal Utility District

Phone Number: (512) 238-0606

Fax Number: (512) 238-7323

Email: halanis@fernbluffmud.org

Mailing Address: 7320 Wyoming Springs Dr.

City, State, and Zip Code: Round Rock, TX 78681

i) Discharge Information

1. What is the name of the waterbody(ies) receiving stormwater discharges from the MS4? Brushy Creek
2. What is the classified segment number(s) that the discharges will eventually reach? 1244-04

Does the small MS4 discharge directly or indirectly into the classified segment(s)?

Directly

Indirectly

3. Are any of the waterbody(ies) receiving discharges from the small MS4 identified as impaired waters (Category 4 or 5) in the *Texas Integrated Report of Surface Water Quality*?

Yes

What is the name of the impaired waterbody(ies) receiving the discharge from the small MS4? Brushy Creek

What is/are the pollutants(s) of concern? Bacteria

No

4. Does the impaired water body(ies) have a TMDL (Category 4 waterbody)?

Yes

What is/are the pollutants with a TMDL?

No

5. Does your MS4 discharge into any other MS4 entity's jurisdiction prior to discharge into water in the state?

Yes

What is the name of the MS4 operator?

No

6. Edwards Aquifer Rule

Is the discharge or potential discharge within the Recharge Zone, Contributing Zone, within the Contributing Zone within the Transition Zone, or zero to ten (0 to 10) miles upstream of the Recharge Zone of the Edwards Aquifer?

Yes - **NOTE: A copy of the agency approved Water Pollution Abatement Plan (WPAP) required by the Edwards Aquifer Rule (30 TAC Chapter 213) must be either included or referenced in the SWMP.**

No

j) Public Participation Process

1. Provide the name and contact information of the person responsible for publishing notice of the executive director's preliminary determination on the MS4's NOI and SWMP?

Prefix (Mr. or Ms.): Mrs.

First and Last Name: Suzanne McCalla

Title: Paralegal

Company: McGinnis Lochridge

Phone Number: (512) 495-6139

Fax Number:

Email: smccalla@mcginnislaw.com

Mailing Address: 600 Congress Avenue, Suite 2100

Internal Routing (Mail Code, Etc.):

City, State, and Zip Code: Austin, TX 78701

2. Provide the name and location of the public place where copies of the NOI, SWMP, Small MS4 General Permit TXR040000, and general permit fact sheet may be viewed and copied by the public?

Name of Public Place: Fern Bluff MUD Community Center

Address of Public Place: 7320 Wyoming Springs Dr. Round Rock, TX 78681

County of Public Place: Williamson

3. Provide the address for the website where the MS4's SWMP and annual report will be posted. fernbluffmud.org

Do not have a website.

Section 6. CERTIFICATION

I certify that I have obtained a copy and understand the terms and conditions of the Phase II (Small) MS4 General Permit TXR040000 issued January 24, 2019.

Yes

I certify that the small MS4 qualifies for coverage under the Phase II (Small) MS4 General Permit TXR040000.

Yes

I understand that a Notice of Termination (NOT) must be submitted when this authorization is no longer needed.

Yes

I understand that authorizations active on September 1st of each year will be assessed an Annual Water Quality Fee.

Yes

Operator Certification

Operator Signatory Name: Janey Miller

Operator Signatory Title: General Manager

I certify under penalty of law that this document and all attachments were prepared under my direction or supervision in accordance with a system designed to assure that qualified personnel properly gather and evaluate the information submitted. Based on my inquiry of the person or persons who manage the system, or those persons directly responsible for gathering the information, the information submitted is, to the best of my knowledge and belief, true, accurate, and complete. I am aware there are significant penalties for submitting false information, including the possibility of fine and imprisonment for knowing violations.

I further certify that I am authorized under 30 Texas Administrative Code §305.44 to sign and submit this document, and can provide documentation in proof of such authorization upon request.

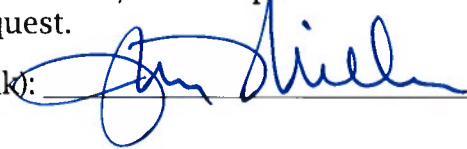
Signature (use blue ink):  Date: 7-17-2019

STORMWATER MANAGEMENT PROGRAM (SWMP) COVER SHEET

This cover sheet **MUST** be attached to the front of the SWMP.

Operator

Operator name: Fern Bluff Municipal Utility District

Required Program Elements

The SWMP needs to include:

- BMPs and measurable goals that are clear, specific, and measurable,
- Annual Reporting Year selected, and
- Estimated population served by the MS4.

Legal Authorities

Include in the SWMP the list of local legal authorities (i.e., ordinance, rule) that the MS4 has adopted to implement any of the MCMs. List all and what MCM they each cover.

Minimum Control Measures

For each MCM, complete the table by entering the page number where the required element can be found in the SWMP

MCM 1: Public Education, Outreach, and Involvement

Table 1: Required Elements for MCM 1

MCM 1 Required Elements	SWMP page number
SWMP includes a stormwater education and outreach program to educate public employees, business, and the general public about hazards associated with the illegal discharges and improper disposal of waste and about the impacts stormwater can have on water quality, and steps they can take to reduce pollutants in stormwater	11
Clearly define the goals and objectives of the program based on high-priority community-wide issues	11
Identify the target audiences	11
Develop or use appropriate educational material	11
Procedures to distribute educational material	11
Make the educational material available to the target audience at least annually	11

MCM 1 Required Elements	SWMP page number
Post the SWMP and annual reports on the MS4's website, if the MS4 has a website	10
Include the MS4's website address where the SWMP and annual reports will be found, if the MS4 has a website	10
SWMP includes a program that complies with state and local public notice requirements	
Include public input in the implementation of the program	
Include opportunities for citizen to participate in implementation of control measures	11
Ensure the public can easily can find information about the SWMP.	11
SWMP lists Best Management Practices (BMPs) used to fulfill this MCM. Examples of possible BMPs could be stream-clean-ups, storm drain stenciling, volunteer water quality monitoring, brochures, billboards, and websites.	11
SWMP includes measurable goals that are clear, specific, and measurable, and the method of measurement, for addressing stormwater quality	11
SWMP has been fully implemented, or includes a schedule of implementation not to exceed five (5) years from the general permit issuance date of January 24, 2019	16

MCM 2: Illicit Discharge Detection and Elimination

Table 2: Required Elements for MCM 2

MCM 2 Required Elements	SWMP page number
Description of the program that will be used to detect, investigate and eliminate illicit discharges. The program includes a plan to detect and address illicit discharges, including illegal dumping to the MS4 system.	11
MS4 map: The map includes: <ul style="list-style-type: none"> • Location of all small MS4 outfalls operated by the MS4 and that discharge into waters of the U.S.; • Location and name of all surface waters receiving discharge from the MS4s outfalls; • For Level 3 and 4 small MS4s: Location of MS4 owned or operated facilities and stormwater controls; and • For Level 4 small MS4s: Location of priority areas. 	17,18
Methods for informing and training MS4 field staff	11
Procedures for tracing the source of an illicit discharge	11

MCM 2 Required Elements	SWMP page number
Procedures for removing the source of the illicit discharge	11
Procedures to facilitate public reporting of illicit discharges or water quality impacts associated with discharges into or from the small MS4	11
Procedures for responding to illicit discharges and spills	11
Procedures for inspections in response to complaints	11
For Level 2, 3, and 4 small MS4: Procedures to prevent and correct leaking on-site sewage disposal systems	11
For Level 3 and 4 small MS4s: Procedures for follow-up investigation to verify that the illicit discharge has been eliminated	NA
For Level 4 small MS4s: Procedures for identifying and creating a list of priority areas within the small MS4s likely to have illicit discharges	NA
For Level 4 small MS4s: Procedures for a dry weather field screening program to assist in detecting and eliminating illicit discharges to the small MS4. Dry weather field screening consists of (1) field observations and (2) field screening.	NA
For Level 4 small MS4s: Procedures to reduce the discharge of floatables in the small MS4	NA
SWMP lists BMPs used to fulfill this MCM. Examples of possible BMPs could be hazardous materials disposal opportunities, inspections of the storm sewer system, and dye testing.	11
SWMP includes measurable goals that are clear, specific, and measurable, and the method of measurement, for addressing stormwater quality	11
SWMP has been fully implemented, or includes a schedule of implementation not to exceed five (5) years from the general permit issuance date of January 24, 2019	16

MCM 3: Construction Site Stormwater Runoff Control

Table 3: Required Elements for MCM 3

MCM 3 Required Elements	SWMP page number
Program requires operators of construction sites one acre and greater (including larger common plan) to select, install, implement, and maintain stormwater control measures	11
Description of ordinance or other regulatory mechanism to require erosion and sediment controls, as well as sanctions to ensure compliance, to the extent allowable under state and local law	11

MCM 3 Required Elements	SWMP page number
Program requires construction site operators to implement BMPs for erosion and sediment control	11
Program requires construction site operators to have procedures for initiating and completing soil stabilization measures	11
Program requires construction site operators to implement BMPs to control pollutants from equipment and vehicle washing and other wash waters	11
Program requires construction site operators to implement BMPs to minimize exposure to stormwater of building materials, building products, construction wastes, trash, landscape materials, fertilizers, pesticides, herbicides, detergents, sanitary waste, and other materials	11
Program requires construction site operators to implement BMPs to minimize the discharge of pollutants from spills and leaks.	11
Program ensures that the construction site has developed a stormwater pollution prevention plan in accordance with the TPDES Construction General Permit TXR150000	11
Program prohibits illicit discharges such as wash out wastewater, fuels, oils, soaps, solvents, and dewatering activities	11
Procedures for construction site plan review to consider water quality impacts	11
Procedures for construction site inspections and enforcement of control measures, to the extent allowable under state and local law	11
Procedures for receipt and consideration of information submitted by the public	11
Procedures for MS4 staff training	11
For Level 3, and 4 small MS4s: Procedures to develop and maintain an inventory of all permitted active public and private construction sites greater than one acre (and sites that are less than one acre if part of larger common plan of development or sale)	NA
SWMP lists BMPs used to fulfill this MCM. Examples may include: notification to discharger of responsibilities under TPDES CGP; hire staff to review construction site plans; provide a web page for public input on construction activities; perform site inspections and enforcement; provide education and training for construction site operators; and mechanism to prohibit discharges into MS4 where necessary.	11
SWMP includes measurable goals that are clear, specific, and measurable, and the method of measurement, for addressing stormwater quality	11

MCM 3 Required Elements	SWMP page number
SWMP has been fully implemented, or includes a schedule of implementation not to exceed five (5) years from the general permit issuance date of January 24, 2019	16

MCM 4: Post Construction Stormwater Management in New Development and Redevelopment

Table 4: Required Elements for MCM 4

MCM 4 Required Elements	SWMP page number
Description of a program that will be developed, implemented and enforced, to control stormwater discharges from private and public new development and redeveloped sites that discharge into the small MS4 that disturb one acre or more (and sites that disturb less than one acre that are part of a larger common plan of development or sale)	12
Description of ordinance or other regulatory mechanism that is in place or planned which will regulate discharges from new development and redevelopment projects	12
Establish, implement, and enforce a requirement that owners or operators of new development and redeveloped sites design, install, implement, and maintain a combination of structural and non-structural BMPs appropriate for the community and that protects water quality	12
Procedures to document and maintain records of enforcement actions	12
Procedures to ensure long-term operation and maintenance of post construction stormwater control measures	12
Operation and maintenance of post construction stormwater control measures is documented	12
For Level 4 small MS4s: Develop and implement an inspection program to ensure that all post construction stormwater control measures are operating correctly and are being maintained. Inspections must be documented	NA
SWMP lists BMPs used to fulfill this MCM. Examples may include: local ordinance in place or planned; guidance document for developers to use; specific BMPs established for particular watersheds; list of appropriate BMPs provided to operators; elimination of curbs and gutters; incentives for use of permeable choices, such as porous pavement; requirements for wet ponds or other BMPs for certain size sites; and xeriscaping.	12
SWMP includes measurable goals that are clear, specific, and measurable, and the method of measurement, for addressing stormwater quality	12

MCM 4 Required Elements	SWMP page number
SWMP has been fully implemented, or includes a schedule of implementation not to exceed five (5) years from the general permit issuance date of January 24, 2019	12

MCM 5: Pollution Prevention and Good Housekeeping for Municipal Operations

Table 5: Required Elements for MCM 5

MCM 5 Required Elements	SWMP page number
Description of an operation and maintenance (O&M) program, including an employee training component, to reduce/prevent pollution from municipal activities and municipally owned areas included but not limited to park and open space maintenance; street, road, or highway maintenance; fleet and building maintenance; stormwater system maintenance; new construction and land disturbances; municipal parking lots; vehicle and equipment maintenance and storage yards; waste transfer stations; and salt/sand storage locations	12
Develop and maintain an inventory of facilities and stormwater controls that are owned or operated by the MS4	12
Procedures to inform or train staff involved in implementing pollution prevention and good housekeeping practices. Maintain training attendance records	12
Procedures to remove and properly dispose of waste from the MS4	12
Contractors hired by the MS4 must be required to comply with operating procedures. Develop contractor oversight procedures	12
Evaluate O&M activities for their potential to discharge pollutants in stormwater for road and parking lot maintenance, bridge maintenance, cold weather operations, right-of-way maintenance, etc.	12
Identify pollutants of concern that could be discharged from the O&M activities	12
Develop and implement pollution prevention measures that will reduce discharge of pollutants from O&M activities	12
Conduct inspections of pollution prevention measures and maintain inspection log	12
Procedures for inspecting and maintaining structural controls	12
For Level 3 and 4 small MS4s: Develop and implement an O&M program to reduce the collection of pollutants in catch basins and other surface structures in the storm sewer system	NA

MCM 5 Required Elements	SWMP page number
For Level 3 and 4 small MS4s: Develop a list of potential problem areas in the storm sewer system for increased inspection (for example, areas with recurring illegal dumping)	NA
For Level 3 and 4 small MS4s: Implement an O&M program to reduce discharge of pollutants from roads that includes at least a street sweeping and cleaning program, or inlet protection. The program includes an implementation schedule and a waste disposal procedure	NA
For Level 3 and 4 small MS4s: Assess its facilities for their potential to discharge pollutants into stormwater and identify high priority facilities that have a high potential to generate stormwater pollutants. At a minimum, facilities include the MS4s maintenance yards, hazardous waste facilities, fuel storage locations, and any other facilities at which chemicals or other materials have a high potential to be discharged in stormwater. Document the results of the assessments	NA
For Level 3 and 4 small MS4s: Develop facility specific stormwater management Standard Operation Procedures for high priority facilities	NA
For Level 3 and 4 small MS4s: MS4 implements stormwater controls at high priority facilities that address good housekeeping; de-icing and anti-icing storage; fueling operations and vehicle maintenance; equipment and vehicle washing	NA
For Level 3 and 4 small MS4s: Develop and implement an inspection program that includes high priority facilities	NA
For Level 4 small MS4s: Develop an application and management program for pesticides, herbicides, and fertilizers used at public open spaces. Implement the following: educational activities, permits, etc for applicators and distributors; encourage of non-chemical solutions for pest management; develop schedules that minimizes discharge of pollutants; ensure collection and proper disposal of unused pesticides, herbicides, and fertilizers	NA
For Level 4 small MS4s: Evaluate flood control projects. Design, construct, and maintain new flood control structures to provide erosion prevention and pollutant removal from stormwater. Retrofitting of existing structural flood control devices is implemented to the maximum extent practicable (MEP)	NA
SWMP lists BMPs used to fulfill this MCM. Examples may include: BMPs which address fleet vehicle maintenance/washing; BMPs which address parking lot and street cleaning; catch basin and storm drain system cleaning; landscaping and lawn care (e.g. xeriscaping); waste materials management; road salt application and storage practices; used oil recycling; pest management practices; fire training facilities; BMPs which address roadway and bridge maintenance; golf course maintenance/waste	NA

MCM 5 Required Elements	SWMP page number
disposal; disposal of cigarette butts; and park maintenance (e.g., providing trash bags).	
SWMP includes measurable goals that are clear, specific, and measurable, and the method of measurement, for addressing stormwater quality	12
SWMP has been fully implemented, or includes a schedule of implementation not to exceed five (5) years from the general permit issuance date of January 24, 2019	12

MCM 6: Industrial Stormwater Sources

Table 6: Required Elements for MCM 6

MCM 6 Required Elements	SWMP page number
For Level 4 MS4 only: Identify and control industrial stormwater sources that at least includes the MS4's landfills; other treatment, storage, or disposal facilities for municipal waste; hazardous waste treatment, storage, disposal and recovery facilities; and facilities that are subject to Emergency Planning and Community Right-to-Know Act (EPCRA).	NA
For Level 4 MS4 only: Procedures for inspecting and implementing control measures for discharges from industrial stormwater sources.	NA

Optional MCM 7: Municipal Construction Activities

This MCM is only applicable where the small MS4 has selected to be the construction site operator for their municipal construction activities. This MCM provides an alternative to the MS4 operator seeking discharge authorization under the Construction Stormwater General Permit TXR150000.

Table 7: Required Elements for MCM 7

MCM 7 Required Elements	SWMP page number
Description of how municipal construction activities will be conducted so as to take into consideration local conditions of weather, soils, and other site specific considerations	NA
Description of the area that this MCM will address and where the MS4 operator's municipal construction activities are covered (e.g. within the boundary of the urbanized area, the corporate boundary, a special district boundary, an extra territorial jurisdiction, or other similar jurisdictional boundary)	NA

MCM 7 Required Elements	SWMP page number
If the area included in this MCM includes areas outside of the UA, then all MCMs (MCM 1 through MCM 7) will be implemented over those additional areas as well	NA
Description of how contractor activities will be supervised or overseen to ensure that the Stormwater Pollution Prevention Plan (SWP3) requirements are properly implemented at the construction site(s); or how the MS4 operator will make certain that contractors have a separate authorization for stormwater discharges if needed	NA
General description of how a construction SWP3 will be developed for each municipal construction site	NA
Records of municipal construction activities authorized under this optional MCM	NA

Texas Commission on Environmental Quality General Permit Payment Submittal Form

Use this form to submit your Application Fee only if you are mailing your payment.

- Complete items 1 through 5 below.
- Staple your check in the space provided at the bottom of this document.
- Do not mail this form with your NOI form.
- Do not mail this form to the same address as your NOI.

Mail this form and your check to:

BY REGULAR U.S. MAIL

Texas Commission on Environmental
Quality
Financial Administration Division
Cashier's Office, MC-214
P.O. Box 13088
Austin, TX 78711-3088

BY OVERNIGHT/EXPRESS MAIL

Texas Commission on Environmental
Quality
Financial Administration Division
Cashier's Office, MC-214
12100 Park 35 Circle
Austin, TX 78753

Fee Code: GPA

General Permit: TXR040000

1. Check / Money Order No:
2. Amount of Check/Money Order:
3. Date of Check or Money Order:
4. Name on Check or Money Order:
5. NOI INFORMATION

If the check is for more than one NOI, list each Project/Site (RE) Name and Physical Address exactly as provided on the NOI. DO NOT SUBMIT A COPY OF THE NOI WITH THIS FORM AS IT COULD CAUSE DUPLICATE PERMIT ENTRIES.

If more space is needed, you may attach a list.

Project/Site (RE) Name:

Project/Site (RE) Physical Address:

Staple Check in This Space

Instructions for Notice of Intent (NOI) for Small Municipal Separate Storm Sewer Systems (MS4) authorized under TPDES Phase II MS4 General Permit TXR040000

GENERAL INFORMATION

Where to Send the Notice of Intent (NOI)

You are required to submit the original and one copy of the NOI, Core Data Form(s), Stormwater Management Program (SWMP) Cover Sheet, and the SWMP. Submit these documents to one of the following addresses:

BY REGULAR U.S. MAIL:

Texas Commission on Environmental
Quality
ARP Team (MC-148)
P.O. Box 13087
Austin, Texas 78711-3087

BY OVERNIGHT/EXPRESS MAIL:

Texas Commission on Environmental
Quality
ARP Team (MC-148)
12100 Park 35 Circle
Austin, TX 78753

Fees Associated with this General Permit

The application fee of \$400 is required to be paid at the time the NOI is submitted. Failure to submit payment at the time the application is filed will cause delays in acknowledgment or denial of coverage under the general permit. Payment of the fee may be made by check or money order, payable to TCEQ, or through EPAY (electronic payment through the web).

Mailed Payments:

Use the attached General Permit Payment Submittal Form. The application fee is submitted to a different address than the NOI. Read the General Permit Payment Submittal Form for further instructions.

Where to Send the Payment

BY REGULAR U.S. MAIL:

Texas Commission on Environmental
Quality
Financial Administration Division
Cashier's Office, MC 214
P.O. Box 13088
Austin, Texas 78711-3087

BY OVERNIGHT/EXPRESS MAIL:

Texas Commission on Environmental
Quality
Financial Administration Division
Cashier's Office, MC 214
12100 Park 35 Circle
Austin, TX 78753

ePAY Electronic Payment: <http://www.tceq.texas.gov/epay>

When making the payment you must select Water Quality, and then select the fee category "General Permit MS4 Phase II Stormwater Discharge NOI Application". You must include a copy of the payment voucher with your NOI. Your NOI will not be considered complete without the payment voucher.

Annual Water Quality Fee

This fee is assessed to permittees with an active authorization under the general permit on September 1 of each year. The designated billing contact will receive an invoice for payment of the annual fee in November of each year. The payment will be due 30 days from the invoice.

A 5% penalty will be assessed if the payment is not received by TCEQ by the due date. Annual fee assessments cannot be waived as long as the authorization under the general permit is active on September 1.

It is important for the permittees to submit an NOT when coverage under the general permit is no longer required. An NOT is effective on the postmarked date of mailing the form to TCEQ. If the NOT is mailed it is recommended that the NOT be mailed using a method that documents the date mailed and received by TCEQ.

Mailed Payments:

You must return your payment with the billing coupon provided with the billing statement.

ePAY Electronic Payment: <http://www.tceq.texas.gov/epay>

You must enter your account number provided at the top portion of your billing statement. Payment methods include American Express, MasterCard, Visa, and electronic check payment (ACH).

TCEQ Contact List

Small Business & Local Government Assistance	800-447-2827
Application - status and form questions:	512-239-4671
Technical questions:	512-239-4671
Environmental Law Division:	512-239-0600
Records Management - obtain copies of forms:	512-239-0900
Reports from databases (as available):	512-239-DATA (3282)
Cashier's office:	512-239-0357 or 512-239-0187

Notice of Intent Process

When your Core Data Form, NOI, and SWMP are received by the program, the form will be processed as follows:

Administrative Review: Each item on the form will be reviewed for a complete response. In addition, the operator's legal name must be verified with Texas Secretary of State as valid and active (if applicable). The address(s) on the form must be verified with the US Postal service as receiving regular mail delivery. Do not give an overnight/express mailing address.

Notice of Deficiency: If an item is incomplete or not verifiable as indicated above, a notice of deficiency (NOD) will be mailed to the operator. The operator will have 30 days to respond to the NOD. The response will be reviewed for completeness.

Technical Review of SWMP: The NOI and SWMP will be reviewed to verify compliance with the requirements in the general permit. More information may

be requested by phone or technical NOD letter mailed to the SWMP contact. When a determination is made that the SWMP meets the requirements of the general permit, the Executive Director's preliminary determination will be prepared and filed with the TCEQ Office of Chief Clerk (OCC).

Public Participation Process: The OCC will mail the Executive Director's preliminary determination to the public participation contact provided in the NOI. This individual must publish the notice in the newspaper of largest circulation in the county where the small MS4 is located.

The comment period begins on the first date the notice is published and ends 30 days later, unless a public meeting is held. If a public meeting is held, the comment period will end at the closing of the public meeting.

The applicant must submit a copy of the newspaper clipping and an affidavit signed by the newspaper staff to the OCC within 60 days of receiving the written instructions from the OCC.

If significant public interest exists, the executive director will direct the applicant to publish notice of the meeting and to hold the public meeting. The applicant must publish the notice of public meeting at least 30 days prior to the public meeting and hold the meeting in the county where the MS4 is located.

Acknowledgment of Coverage: An Acknowledgment Certificate will be mailed to the operator. This certificate acknowledges coverage under the general permit.

or

Denial of Coverage: Coverage may be denied if the operator fails to respond to the NOD, the response is inadequate, or the NOI and SWMP do not meet the requirements of the general permit. If coverage is denied, the operator will be notified.

General Permit

Coverage under the general permit begins upon approval of the NOI, Core Data Form, and SWMP by TCEQ and after the public notice process has been completed. You should have a copy of your general permit when submitting your application. You may view and print your permit for which you are seeking coverage, at the following website <http://www.tceq.texas.gov>. Search using keyword TXR040000.

General Permit Forms

The Notice of Intent (NOI), Notice of Termination (NOT), Notice of Change (NOC) and Core Data Form (including instructions) are available at the TCEQ web site <http://www.tceq.texas.gov>.

Change in Operator

An authorization under the general permit is not transferable. If the operator changes, the present permittee must submit a Notice of Termination (NOT) and the new operator must submit a Notice of Intent and a Core Data Form. The NOT, NOI and Core Data Form must be submitted no later than 10 days prior to the change in status.

INSTRUCTIONS FOR FILLING OUT THE FORM

Renewal of General Permit: Dischargers holding an active authorizations under the expired General Permit are required to submit a NOI to continue coverage. The existing authorization number is required. If the authorization number is not provided or has been terminated, expired, or denied a new permit number will be issued.

This number will begin with TXR04. Do not use TXR040000, it is *the general permit number not your* authorization number.

Section 1. Operator (Applicant)

a) Customer Number (CN)

TCEQ assigns each customer a number that begins with CN, followed by nine digits. This is not a permit number, registration number, or license number. If the applicant is an existing TCEQ customer, the Customer Number is available at the following website: <http://www15.tceq.texas.gov/crpub/>. If the applicant is not an existing TCEQ customer, leave the space for CN blank.

b) Legal Name of Applicant

Provide the current legal name of the applicant. The name must be provided exactly as filed with the Texas Secretary of State, or on the legal documents forming the entity as filed with the county. If filed in the county, provide a copy of the legal documents showing the legal name.

c) Core Data Form

Complete and attach a Core Data Form (TCEQ-10400) for each customer.

Section 2. Annual Billing Contact

An annual fee is assessed to each operator holding an active authorization under the general permit on September 1 of each year.

Provide the contact name and complete mailing address where the annual fee invoice should be mailed. Verify the address with the USPS. It must be an address for delivery of regular mail, not overnight express mail.

The phone number should provide contact to the individual responsible for paying the annual fee.

The fax number and e-mail address are optional and should correspond to the individual responsible for paying the annual fee.

Section 3. Application Contact

Provide the name, title and contact information of the person that TCEQ can contact for additional information regarding this application. This contact may be a consultant or entity other than the applicant.

Section 4. Regulated Entity (RE) Information For Site

a) Regulated Entity Reference Number (RN)

The RN is issued by TCEQ to sites where an activity is regulated by TCEQ. This is not a permit number, registration number, or license number. Search TCEQ's Central Registry to see if the site has an assigned RN at

<http://www15.tceq.texas.gov/crpub/>. If this regulated entity has not been assigned an RN, leave this space blank.

b) Name of the Project or Site

Provide the name of the site or project as known by the public in the area where the site is located. The name you provide on this application will be used in the TCEQ Central Registry as the Regulated Entity name.

c) Name of Urbanized Area

List the formal name of the urbanized area(s) where the MS4 is located using the 2010 U.S. Census maps referenced in Section 5. c) below. For example: Dallas-Fort Worth-Arlington Urbanized area.

d) Describe the boundaries of the regulated portion of the small MS4

Briefly describe the boundaries of the regulated portion of the small MS4.

Section 5. General Characteristics

a) Indian Country Lands

If your site is located on Indian Country Lands, the TCEQ does not have authority to process your application. Do not submit this application form to TCEQ. You must obtain authorization through EPA, Region 6, in Dallas.

b) TCEQ "Designated" Small MS4

A small MS4 that is outside of an urbanized area that is formally "designated" by TCEQ is eligible for coverage under this general permit. The small MS4 Operator must obtain authorization under this general permit or apply for coverage under an individual TPDES stormwater permit within 180 days of notification of their designation. If the small MS4 was already designated, please attach a copy of the documentation sent to the MS4 by TCEQ.

c) MS4 Level

The general permit defines MS4s by four different levels, based on the population served within the 2010 U.S. Census urbanized area (UA). "Population served" means the residential population within the regulated portion of the small MS4 based on the 2010 U.S. Census, except for non-traditional small MS4s that are classified as Level 2.

A reference map identifying the 2010 U.S. Census UAs can be found at www.epa.gov/npdes/urbanized-area-maps-npdes-ms4-phase-ii-stormwater-permits.

Districts that did not have a population during the 2010 U.S. Census, are required to apply when their population exceeds the population threshold for permit coverage.

d) Estimated Population

List the current estimated population served by the MS4. This number will not be used to determine the Levels.

e) Coalitions of MS4 entities

Indicate if the MS4 is part of a coalition that share efforts in meeting any or all of the SWMP requirements.

f) Members of the Coalition

List the name of each member of the coalition *and* their unique Phase II MS4 authorization number.

g) Annual Reporting Year

The annual report must address the previous reporting year. The selected reporting year cannot be changed during the permit term.

- If the MS4 selects the calendar year, then the reporting year is from January 1 through December 31 of each year.
- If the MS4 selects the Phase II MS4 General Permit year, the reporting year is from the effective date of the general permit plus 365 days of each year.
- If the MS4 selects the fiscal year, the reporting year is from the first day of the MS4's fiscal year through the last day of the MS4's fiscal year. Provide the month and last day of the MS4's fiscal year.

h) SWMP

1. Certify, by selecting Yes, that the SWMP has been developed in accordance with the general permit requirements and is attached to this NOI.
2. Certify, by selecting Yes, that the SWMP Cover Sheet has been completed and is attached to the front of the SWMP.
3. If the MS4 was previously authorized under the general permit, the program elements in the previous SWMP must be re-assessed and modified. Additionally, new program elements must be developed. Do not submit the exact same SWMP that was previously submitted. Indicate that you have revised the previous SWMP, or that this is a newly regulated MS4.
4. Indicate if the MS4 is seeking coverage under this general permit for the optional MCM 7 for municipal construction activities where the MS4 meets the definition of "construction site operator".

If Yes, the SWMP must include the geographic area or boundary where MCM 7 will be implemented. If this area extends beyond the geographic area or boundary of the urbanized area, then all MCMs 1-7 must be implemented in the urbanized and non-urbanized areas. The MS4 operator can utilize MCM 7 only in areas that are in compliance with the SWMP's MCMs 1-7. If you do **NOT** incorporate the entire SWMP (MCMs 1-7) in the urbanized and the non-urbanized areas, then the MS4 cannot utilize only MCM 7 outside of the urbanized area.

If No, the MS4 can obtain this coverage at any time during the general permit term by submitting a Notice of Change.

5. Provide the name and contact information of the designated person responsible for implementing or coordinating implementation of the SWMP.

i) Discharge Information

1. Provide the name of all waterbodies that receive discharges from the MS4. The discharge eventually reaches a receiving waterbody such as a local stream or lake, possibly via a drainage ditch or even through another MS4 prior to reaching the waterbody. Please note that this general permit does not grant permission to use another MS4 as a conveyance of stormwater and certain non-storm water discharges along the discharge route.
2. Identify the classified segment number(s) that will eventually receive the

discharge. You can find classified segment numbers in the Atlas of Texas Surface Waters at: www.tceq.texas.gov/publications/gi/gi-316 or the Surface Water Quality (Segments) Viewer at:

<https://www.tceq.texas.gov/gis/segments-viewer>

Indicate if the discharge is directly into the classified segment or if it reaches the classified segment after being discharged into another waterbody or MS4.

3. Indicate if any waterbodies receiving discharges are identified as impaired waters (Category 4 or 5) in the *Texas Integrated Report of Surface Water Quality*, which is available at:

http://www.tceq.texas.gov/waterquality/assessment/305_303.html.

If Yes, provide the name(s) of the impaired waterbodies and the pollutants of concern for those waterbodies. The pollutants of concern are the parameters for which the waterbody is impaired.

4. Indicate if the impaired waterbody has a TMDL and list the pollutants with a TMDL (Category 4 waterbody).
5. Indicate if the discharge is into any other MS4 entity's jurisdiction prior to reaching water in the state.

If Yes, provide the name of the MS4 operator that receives the discharge.

6. Edwards Aquifer Rule

Indicate if the discharge or potential discharge is within the Recharge Zone, Contributing Zone, or Contributing Zone within the Transition Zone of the Edwards Aquifer. See maps on the TCEQ website to determine if the site is located within the Recharge Zone, Contributing Zone, or Contributing Zone within the Transition Zone of the Edwards Aquifer at

<https://www.tceq.texas.gov/permitting/eapp/viewer.html>.

If Yes, additional requirements may exist under the Edwards Aquifer Protection Program (30 TAC Chapter 213). For activities regulated under 30 TAC Chapter 213, any required plans must be included in the SWMP. Compliance with any Edwards Aquifer requirements is in addition to the requirements of this general permit.

j) Public Participation

1. Provide the name and contact information of the person responsible for publishing the public notice in the newspaper.
2. Provide the name and location of a public place where copies of the NOI, SWMP, General Permit, and permit fact sheet will be available to the public for viewing. Examples of public places include public libraries, city hall, municipal buildings, etc.
3. Provide the address for the website where the MS4's SWMP and annual report will be posted. Indicate if the MS4 does not have a website.

Section 6. Certifications

Failure to indicate "Yes" to ALL of the certification items may result in denial of coverage under the general permit. The certification must bear an original signature of a person meeting the signatory requirements specified under 30 Texas Administrative Code §305.44.

IF YOU ARE A CORPORATION:

The regulation that controls who may sign an application form is 30 Texas Administrative Code §305.44(a), which is provided below. According to this code provision, any corporate representative may sign an NOI or similar form so long as the authority to sign such a document has been delegated to that person in accordance with corporate procedures. By signing the NOI or similar form, you are certifying that such authority has been delegated to you. The TCEQ may request documentation evidencing such authority.

IF YOU ARE A MUNICIPALITY OR OTHER GOVERNMENT ENTITY:

The regulation that controls who may sign an NOI or similar form is 30 Texas Administrative Code §305.44(a), which is provided below. According to this code provision, only a ranking elected official or principal executive officer may sign an NOI or similar form. Persons such as the City Mayor or County Commissioner will be considered ranking elected officials. In order to identify the principal executive officer of your government entity, it may be beneficial to consult your city charter, county or city ordinances, or the Texas statutes under which your government entity was formed. An NOI or similar document that is signed by a government official who is not a ranking elected official or principal executive officer does not conform to §305.44(a) (3). The signatory requirement may not be delegated to a government representative other than those identified in the regulation. By signing the NOI or similar form, you are certifying that you are either a ranking elected official or principal executive officer as required by the administrative code. Documentation demonstrating your position as a ranking elected official or principal executive officer may be requested by the TCEQ.

If you have any questions or need additional information concerning the signatory requirements discussed above, please contact the Texas Commission on Environmental Quality's Environmental Law Division at 512-239-0600.

30 TEXAS ADMINISTRATIVE CODE §305.44. SIGNATORIES TO APPLICATIONS

(a) All applications shall be signed as follows.

(1) For a corporation, the application shall be signed by a responsible corporate officer. For purposes of this paragraph, a responsible corporate officer means a president, secretary, treasurer, or vice-president of the corporation in charge of a principal business function, or any other person who performs similar policy or decision-making functions for the corporation; or the manager of one or more manufacturing, production, or operating facilities employing more than 250 persons or having gross annual sales or expenditures exceeding \$25 million (in second-quarter 1980 dollars), if authority to sign documents has been assigned or delegated to the manager in accordance with corporate procedures. Corporate procedures governing authority to sign permit or post-closure order applications may provide for assignment or delegation to applicable corporate positions rather than to specific individuals.

(2) For a partnership or sole proprietorship, the application shall be signed by a general partner or the proprietor, respectively.

(3) For a municipality, state, federal, or other public agency, the application shall be signed by either a principal executive officer or a ranking elected official. For purposes of this paragraph, a principal executive officer of a federal agency includes

the chief executive officer of the agency, or a senior executive officer having responsibility for the overall operations of a principal geographic unit of the agency (e.g., regional administrator of the EPA).

SWMP Cover Sheet

The SWMP cover sheet must be completed and placed on the front of the SWMP. Both the SWMP cover sheet and the SWMP must be submitted with the complete NOI.

Provide the name of the MS4 operator.

For each MCM, complete the table by entering the page number (or page number range) where each required program element can be found in the SWMP.

Note: Some program elements are only required for certain MS4 levels. The tables clearly identify these MS4 level specific requirements. If one of these program element does not apply to the MS4 level for this facility, enter NA.

Additionally, MCM 7 is optional. If you selected "No" on the NOI Section 5.e.4 question, enter NA on Table 7.

Print this voucher for your records. If you are sending the TCEQ hardcopy documents related to this payment, include a copy of this voucher.

Transaction Information

Voucher Number: 425790
Trace Number: 582EA000352088
Date: 07/15/2019 03:58 PM
Payment Method: CC - Authorization 0000015536
Amount: \$400.00
Fee Type: GENERAL PERMIT WATER DISCHARGE APPLICATION
ePay Actor: Hector Alanis
Actor Email: halanis@fernbluffmud.org
IP: 71.78.9.194

Payment Contact Information

Name: Hector Alanis
Company: Fern Bluff Mud
Address: 7320 Wyoming Springs Dr, Round Rock, TX 78681
Phone: 512-238-0606

Site Information

Site Name: FERN BLUFF MUNICIPAL UTILITY DISTRICT
Site Address: 7320 WYOMING SPRINGS DR, ROUND ROCK, TX 78681
Site Location: ROUND ROCK TX FERN BLUFF MUNICIPAL UTILITY DISTRICT BRUSHY CREEK TXR040625

Customer Information

Customer Name: FERN BLUFF MUNICIPAL UTILITY DISTRICT
Customer Address: 7320 WYOMING SPRINGS DR, ROUND ROCK, TX 78681

[Close](#)



FERN BLUFF

Municipal Utility District

Texas Pollutant Discharge Elimination System
Small Municipal Separate Storm Sewer System (MS4)

Storm Water Management Program

Permit # TXR040625

Fern Bluff MUD
Small Municipal Separate Storm Sewer System
Storm Water Management Program

Table of Contents

Overview	3
I. Definitions	4
II. The Stormwater Management Plan (SWMP).....	10
III. Minimum Control Measures (MCMs).....	11
IV. Recordkeeping and Reporting.....	13
V. Schedule of Deliverables.....	16
VI. Map	17

Fern Bluff Municipal Utility District Small Municipal Separate Storm Sewer System Storm Water Management Program

Overview

LOCATION - Fern Bluff Municipal Utility District (Fern Bluff MUD or the District) was created in 1986. It covers approximately 717 acres. The center of Fern Bluff MUD is located near Latitude 30° 31' 07" N and Longitude 97° 43' 08" W and has an elevation range of 760 to 860 feet above sea level. Average temperature is approximately 69 degrees F and the average annual rainfall is 31 inches. The regional topography can be described as rolling hills. Fern Bluff MUD has a population of approximately 5,700 and is located within the City of Round Rock extraterritorial jurisdiction (ETJ).

ORGANIZATION - The District is governed by a Board of Directors. Elected officials include a Board President, Vice-President, Secretary, Treasurer and Assistant Secretary/Treasurer. Day to day operations is conducted by in-house staff. The Board hires outside consultants to handle engineering, legal and tax assessment services.

LEGAL AUTHORITY - Fern Bluff MUD is classified as a non-traditional small MS4 and, as such, has limited legal authority to develop ordinances or to implement enforcement actions outside of the realm of its facilities, employees, contractors and any other entity over which it has operational control. As a result, the District will enforce compliance with the Storm Water Management Program through the District's "Order Establishing Water and Wastewater Service Rates, Charges, Tap Fees and Park Fees, and Adopting General Policies with Respect to the District's Water, Wastewater and Drainage Systems" (a.k.a. the District Rate Order). Pursuant to the General Permit requirement (Part III, Section A.2.(b)), the District will revise its Rate Order to reflect language describing the District's plan and adding specific language pertaining to penalties regarding Illicit Discharge and Detection Elimination (IDDE) and SWMP program funding fees. This revision, or series of revisions is planned to occur on or before December 31, 2020.

RESOURCES – The Fern Bluff MUD will fund this program through its General Operating Fund.

LIMITATIONS ON PERMIT COVERAGE - Fern Bluff MUD discharges its storm water into Brushy Creek - Segment 1244-04. The classified segment is listed on the 2014 Texas Integrated Report of Surface Water Quality for the Clean Water Act Sections 305(b) and 303(d) with an impairment of Bacteria.

REPORTING – The Fern Bluff MUD has chosen to follow the "Calendar Year" for its annual reporting requirements.

I. Definitions

Arid Areas - Areas with an average annual rainfall of less than ten (10) inches.

Benchmarks – A benchmark pollutant value is a guidance level indicator that helps determine the effectiveness of chosen best management practices (BMPs). This type of monitoring differs from “compliance monitoring” in that exceedances of the indicator or benchmark level are not permit violations, but rather indicators that can help identify problems at the MS4 with exposed or unidentified pollutant sources; or control measures that are either not working correctly, whose effectiveness need to be re-considered, or that need to be supplemented with additional BMP(s).

Best Management Practices (BMPs) - Schedules of activities, prohibitions of practices, maintenance procedures, structural controls, local ordinances, and other management practices to prevent or reduce the discharge of pollutants. BMPs also include treatment requirements, operating procedures, and practices to control runoff, spills or leaks, waste disposal, or drainage from raw material storage areas.

Catch basins - Storm drain inlets and curb inlets to the storm drain system. Catch basins typically include a grate or curb inlet that may accumulate sediment, debris, and other pollutants.

Classified Segment - A water body that is listed and described in Appendix A or Appendix C of the Texas Surface Water Quality Standards, at 30 Texas Administrative Code (TAC) § 307.10.

Clean Water Act (CWA) - The Federal Water Pollution Control Act or Federal Water Pollution Control Act Amendments of 1972, Pub.L. 92-500, as amended Pub. L. 95-217, Pub. L. 95-576, Pub. L. 96-483 and Pub. L. 97-117, 33 U.S.C. 1251 et. seq.

Common Plan of Development or Sale - A construction activity that is completed in separate stages, separate phases, or in combination with other construction activities. A common plan of development or sale is identified by the documentation for the construction project that identifies the scope of the project, and may include plats, blueprints, marketing plans, contracts, building permits, a public notice or hearing, zoning requests, or other similar documentation and activities.

Construction Activity - Soil disturbance, including clearing, grading, excavating, and other construction related activities (e.g., stockpiling of fill material and demolition); and not including routine maintenance that is performed to maintain the original line and grade, hydraulic capacity, or original purpose of the site (e.g., the routine grading of existing dirt roads, asphalt overlays of existing roads, the routine clearing of existing right-of-ways, and similar maintenance activities). Regulated construction activity is defined in terms of small and large construction activity.

Small Construction Activity is construction activity that results in land disturbance of equal to or greater than one (1) acre and less than five (5) acres of land. Small construction activity also includes the disturbance of less than one (1) acre of total land area that is part of a larger common plan of development or sale if the larger common plan will ultimately disturb equal to or greater than one (1) and less than five (5) acres of land.

Large Construction Activity is construction activity that results in land disturbance of equal to or greater than five (5) acres of land. Large construction activity also includes the disturbance of less than five (5) acres of total land area that is part of a larger common plan of development or sale if the larger common plan will ultimately disturb equal to or greater than five (5) acres of land.

Construction Site Operator - The entity or entities associated with a small or large construction project that meet(s) either of the following two criteria:

(a) The entity or entities that have operational control over construction plans and

specifications (including approval of revisions) to the extent necessary to meet the requirements and conditions of this general permit; or

(b) The entity or entities that have day-to-day operational control of those activities at a construction site that are necessary to ensure compliance with a stormwater pollution prevention plan (SWP3) for the site or other permit conditions (for example they are authorized to direct workers at a site to carry out activities required by the SWP3 or comply with other permit conditions).

Control Measure - Any BMP or other method used to prevent or reduce the discharge of pollutants to water in the state.

Conveyance - Curbs, gutters, man-made channels and ditches, drains, pipes, and other constructed features designed or used for flood control or to otherwise transport stormwater runoff.

Discharge - When used without a qualifier, refers to the discharge of stormwater runoff or certain non-stormwater discharges as allowed under the authorization of this general permit.

Edwards Aquifer - As defined in 30 TAC §213.3 (relating to the Edwards Aquifer), that portion of an arcuate belt of porous, water-bearing, predominantly carbonate rocks known as the Edwards and Associated Limestones in the Balcones Fault Zone trending from west to east to northeast in Kinney, Uvalde, Medina, Bexar, Comal, Hays, Travis, and Williamson Counties; and composed of the Salmon Peak Limestone, McKnight Formation, West Nueces Formation, Devil's River Limestone, Person Formation, Kainer Formation, Edwards Formation, and Georgetown Formation. The permeable aquifer units generally overlie the less-permeable Glen Rose Formation to the south, overlie the less-permeable Comanche Peak and Walnut Formations north of the Colorado River, and underlie the less permeable Del Rio Clay regionally.

Edwards Aquifer Recharge Zone - Generally, that area where the stratigraphic units constituting the Edwards Aquifer crop out, including the outcrops of other geologic formations in proximity to the Edwards Aquifer, where caves, sinkholes, faults, fractures, or other permeable features would create a potential for recharge of surface waters into the Edwards Aquifer. The recharge zone is identified as that area designated as such on official maps located in the offices of the TCEQ or the TCEQ website.

Final Stabilization - A construction site where any of the following conditions are met:

(a) All soil disturbing activities at the site have been completed and a uniform (for example, evenly distributed, without large bare areas) perennial vegetative cover with a density of 70 percent of the native background vegetative cover for the area has been established on all unpaved areas and areas not covered by permanent structures, or equivalent permanent stabilization measures (such as the use of riprap, gabions, or geotextiles) have been employed.

(b) For individual lots in a residential construction site by either:

(1) The homebuilder completing final stabilization as specified in condition (a) above; or

(2) The homebuilder establishing temporary stabilization for an individual lot prior to the time of transfer of the ownership of the home to the buyer and after informing the homeowner of the need for, and benefits of, final stabilization.

(c) For construction activities on land used for agricultural purposes (for example pipelines across crop or range land), final stabilization may be accomplished by returning the disturbed land to its preconstruction agricultural use. Areas disturbed that were not previously used for agricultural activities, such as buffer strips immediately adjacent to a surface water and areas which are not being returned to their preconstruction agricultural use must meet the final stabilization conditions of

condition (a) above.

(d) In arid, semi-arid, and drought-stricken areas only, all soil disturbing activities at the site have been completed and both of the following criteria have been met:

(1) Temporary erosion control measures (e.g., degradable rolled erosion control product) are selected, designed, and installed along with an appropriate seed base to provide erosion control for at least three years without active maintenance by the operator, and

(2) The temporary erosion control measures are selected, designed, and installed to achieve 70 percent vegetative coverage within three years.

General Permit - A permit issued to authorize the discharge of waste into or adjacent to water in the state for one or more categories of waste discharge within a geographical area of the state or the entire state as provided by Texas Water Code (TWC) §26.040.

Groundwater Infiltration - For the purposes of this permit, groundwater that enters a municipal separate storm sewer system (including sewer service connections and foundation drains) through such means as defective pipes, pipe joints, connections, or manholes.

High Priority Facilities - High priority facilities are facilities with a high potential to generate stormwater pollutants. These facilities must include, at a minimum, the MS4 operator's maintenance yards, hazardous waste facilities, fuel storage locations, and other facilities where chemicals or other materials have a high potential to be discharged in stormwater. Among the factors that must be considered when giving a facility a high priority ranking are: the amount of urban pollutants stored at the site, the identification of improperly stored materials, activities that must not be performed outside (for example, changing automotive fluids, vehicle washing), proximity to waterbodies, proximity to sensitive aquifer recharge features, poor housekeeping practices, and discharge of pollutant(s) of concern to impaired water(s).

Hyperchlorinated Water - Water resulting from hyperchlorination of waterlines or vessels, with a chlorine concentration greater than 10 milligrams per liter (mg/L).

Illicit Connection - Any man-made conveyance connecting an illicit discharge directly to a municipal separate storm sewer.

Illicit Discharge - Any discharge to a municipal separate storm sewer that is not entirely composed of stormwater, except discharges pursuant to this general permit or a separate authorization and discharges resulting from emergency firefighting activities.

Impaired Water - A surface water body that is identified as impaired on the latest approved CWA §303(d) List or waters with an EPA approved or established TMDL that are found on the latest EPA approved *Texas Integrated Report of Surface Water Quality for CWA Sections 305(b) and 303(d)* which lists the category 4 and 5 water bodies.

Implementation Plan (I-Plan) - A detailed plan of action that describes the measures or activities necessary to achieve the pollutant reductions identified in the total maximum daily load (TMDL).

Indian Country - Defined in 18 USC § 1151 as: (a) All land within the limits of any Indian reservation under the jurisdiction of the United States (U.S.) Government, notwithstanding the issuance of any patent, and including rights-of-way running through the reservation; (b) All dependent Indian communities within the borders of the U.S. whether within the original or subsequently acquired territory thereof, and whether within or without the limits of a state; and (c) All Indian allotments, the Indian titles to which have not been extinguished, including rights-of-way running through the same. This definition includes all land held in trust for an Indian tribe.

Indicator Pollutant - An easily measured pollutant, that may or may not impact water quality that indicates the presence of other stormwater pollutants.

Industrial Activity - Any of the ten (10) categories of industrial activities included in the

definition of “stormwater discharges associated with industrial activity” as defined in 40 Code of Federal Regulations (CFR) §122.26(b)(14)(i)-(ix) and (xi).

Infeasible - For the purpose of this permit, infeasible means not technologically possible, or not economically practicable and achievable in light of best industry practices. The TCEQ notes that it does not intend for any small MS4 permit requirement to conflict with state water right laws.

Maximum Extent Practicable (MEP) - The technology-based discharge standard for municipal separate storm sewer systems (MS4s) to reduce pollutants in stormwater discharges that was established by the CWA § 402(p). A discussion of MEP as it applies to small MS4s is found in 40 CFR § 122.34.

MS4 Operator - For the purpose of this permit, the public entity or the entity contracted by the public entity, responsible for management and operation of the small municipal separate storm sewer system that is subject to the terms of this general permit.

Municipal Separate Storm Sewer System (MS4) - A conveyance or system of conveyances (including roads with drainage systems, municipal streets, catch basins, curbs, gutters, ditches, man-made channels, or storm drains):

(a) Owned or operated by the U.S., a state, city, town, borough, county, parish, district, association, or other public body (created by or pursuant to state law) having jurisdiction over the disposal of sewage, industrial wastes, stormwater, or other wastes, including special districts under state law such as a sewer district, flood control district or drainage district, or similar entity, or an Indian tribe or an authorized Indian tribal organization, or a designated and approved management agency under the CWA §208 that discharges to surface water in the state;

(b) That is designed or used for collecting or conveying stormwater;

(c) That is not a combined sewer; and

(d) That is not part of a publicly owned treatment works (POTW) as defined in 40 CFR §122.2.

Non-traditional SmallMS4 - A small MS4 that often cannot pass ordinances and may not have the enforcement authority like a traditional small MS4 would have to enforce the stormwater management program. Examples of non-traditional small MS4s include counties, transportation authorities (including the Texas Department of Transportation), municipal utility districts, drainage districts, military bases, prisons and universities.

Notice of Change (NOC) - A written notification from the permittee to the executive director providing changes to information that was previously provided to the agency in a notice of intent.

Notice of Intent (NOI) - A written submission to the executive director from an applicant requesting coverage under this general permit.

Notice of Termination (NOT) - A written submission to the executive director from a permittee authorized under a general permit requesting termination of coverage under this general permit.

Outfall - A point source at the point where a small MS4 discharges to waters of the U.S. and does not include open conveyances connecting two municipal separate storm sewers, or pipes, tunnels, or other conveyances that connect segments of the same stream or other waters of the U.S. and are used to convey waters of the U.S. For the purpose of this permit, sheet flow leaving a linear transportation system without channelization is not considered an outfall. Point sources such as curb cuts; traffic or right-of-way barriers with drainage slots that drain into open culverts, open swales or an adjacent property, or otherwise not actually discharging into waters of the U.S. are not considered an outfall.

Permittee - The MS4 operator authorized under this general permit.

Point Source - (from 40 CFR § 122.22) any discernible, confined, and discrete conveyance, including but not limited to, any pipe, ditch, channel, tunnel, conduit, well, discrete fissure, container, rolling stock, concentrated animal feeding operation, landfill leachate collection system, vessel or other floating craft from which pollutants are or may be discharged. This term does not include return flows from irrigated agriculture or agricultural stormwater runoff.

Pollutant(s) of Concern – For the purpose of this permit, includes biochemical oxygen demand (BOD), sediment or a parameter that addresses sediment (such as total suspended solids (TSS), turbidity or siltation), pathogens, oil and grease, and any pollutant that has been identified as a cause of impairment of any water body that will receive a discharge from an MS4. (Definition from 40 CFR § 122.32(e)(3)).

Redevelopment - Alterations of a property that changed the "footprint" of a site or building in such a way that there is a disturbance of equal to or greater than one (1) acre of land. This term does not include such activities as exterior remodeling, routine maintenance activities, and linear utility installation.

Semiarid Areas - Areas with an average annual rainfall of at least ten (10) inches, but less than 20 inches.

Small Municipal Separate Storm Sewer System (MS4) – A conveyance or system of conveyances (including roads with drainage systems, municipal streets, catch basins, curbs, gutters, ditches, manmade channels, or storm drains):

- (a) Owned or operated by the U.S., a state, city, town, borough, county, district, association, or other public body (created by or pursuant to State law) having jurisdiction over disposal of sewage, industrial wastes, stormwater, or other wastes, including special districts under state law such as a sewer district, flood control district or drainage district, or similar entity, or an Indian tribe or an authorized Indian tribal organization, or a designated and approved management agency under CWA § 208;
- (b) Designed or used for collecting or conveying stormwater;
- (c) Which is not a combined sewer;
- (d) Which is not part of a POTW as defined in 40 CFR § 122.2; and
- (e) Which was not previously regulated under a National Pollutant Discharge Elimination System (NPDES) or a Texas Pollutant Discharge Elimination System (TPDES) individual permit as a medium or large municipal separate storm sewer system, as defined in 40 CFR §§ 122.26(b)(4) and (b)(7).

This term includes systems similar to separate storm sewer systems at military bases, large hospitals or prison complexes, and highways and other thoroughfares. This term does not include separate storm sewers in very discrete areas, such as individual buildings. For the purpose of this permit, a very discrete system also includes storm drains associated with certain municipal offices and education facilities serving a nonresidential population, where those storm drains do not function as a system, and where the buildings are not physically interconnected to a small MS4 that is also operated by that public entity.

Stormwater and Stormwater Runoff - Rainfall runoff, snow melt runoff, and surface runoff and drainage.

Stormwater Associated with Construction Activity - Stormwater runoff from an area where there is either a large construction or a small construction activity.

Stormwater Management Program (SWMP) - A comprehensive program to manage the quality of discharges from the municipal separate storm sewer system.

Structural Control (or Practice) - A pollution prevention practice that requires the construction of a device, or the use of a device, to capture or prevent pollution in stormwater runoff. Structural controls and practices may include but are not limited to: wet ponds, bioretention, infiltration basins, stormwater wetlands, silt fences, earthen dikes, drainage

swales, vegetative lined ditches, vegetative filter strips, sediment traps, check dams, subsurface drains, storm drain inlet protection, rock outlet protection, reinforced soil retaining systems, gabions, and temporary or permanent sediment basins.

Surface Water in the State - Lakes, bays, ponds, impounding reservoirs, springs, rivers, streams, creeks, estuaries, wetlands, marshes, inlets, canals, the Gulf of Mexico inside the territorial limits of the state (from the mean high water mark (MHW) out 10.36 miles into the Gulf), and all other bodies of surface water, natural or artificial, inland or coastal, fresh or salt, navigable or nonnavigable, and including the beds and banks of all water courses and bodies of surface water, that are wholly or partially inside or bordering the state or subject to the jurisdiction of the state; except that waters in treatment systems which are authorized by state or federal law, regulation, or permit, and which are created for the purpose of waste treatment are not considered to be water in the state.

Total Maximum Daily Load (TMDL) - The total amount of a substance that a water body can assimilate and still meet the Texas Surface Water Quality Standards.

Traditional Small MS4 - A small MS4 that can pass ordinances and have the enforcement authority to enforce the stormwater management program. An example of traditional MS4s includes cities.

Urbanized Area (UA) - An area of high population density that may include multiple small MS4s as defined and used by the U.S. Census Bureau in the 2000 and the 2010 Decennial Census.

Waters of the United States - (According to 40 CFR § 122.2) Waters of the United States or waters of the U.S. means:

- (a) All waters which are currently used, were used in the past, or may be susceptible to use in interstate or foreign commerce, including all waters which are subject to the ebb and flow of the tide;
- (b) All interstate waters, including interstate wetlands;
- (c) All other waters such as intrastate lakes, rivers, streams (including intermittent streams), mudflats, sandflats, wetlands, sloughs, prairie potholes, wet meadows, playa lakes, or natural ponds that the use, degradation, or destruction of which would affect or could affect interstate or foreign commerce including any such waters:
 - (1) Which are or could be used by interstate or foreign travelers for recreational or other purposes;
 - (2) From which fish or shellfish are or could be taken and sold in interstate or foreign commerce; or
 - (3) Which are used or could be used for industrial purposes by industries in interstate commerce;
- (d) All impoundments of waters otherwise defined as waters of the United States under this definition;
- (e) Tributaries of waters identified in paragraphs (a) through (d) of this definition;
- (f) The territorial sea; and
- (g) Wetlands adjacent to waters (other than waters that are themselves wetlands) identified in paragraphs (a) through (f) of this definition.

II. The Stormwater Management Plan (SWMP)

- a. The plan for Fern Bluff MUD has been revised and updated to better comply with the TPDES General Permit TXR040000 issued January 24, 2019 (the General Permit). The District will focus on the Minimum Control Measures including:
MCM1- Public Education/Outreach and Involvement;
MCM 2 - Illicit Discharge Detection and Elimination;
MCM 5 - Pollution Prevention and Good Housekeeping for Municipal Operations. And, to a lesser degree,
MCM 3 - Construction Site Stormwater Runoff Control; and
MCM 4 - Post Construction Stormwater Management in New Development and Redevelopment.

The reasoning for limited focus on MCMs 3 and 4 is because the District is landlocked, built out and except for a school and the District's six parks, does not have any lots larger than one acre. It is important to note that there is no construction slated for any of the properties larger than one acre in the foreseeable future. In addition, many if not all the properties mentioned have limited construction flexibility mainly due to karst features prohibiting expansion.

The following section details the Best Management Practices (BMPs) for each of the Minimum Control Measures required by the permit. This Plan, its application and annual reports will be posted on the District's website, www.fernbluffmud.org. Unless otherwise stated, the responsible group for overseeing the day to day functions and requirements of this plan is delegated to the Operations Department and its management.

III. Minimum Control Measures (MCMs)

1. Public Education, Outreach and Involvement

- a. **BMP - Staff training on stormwater**
Goal - Staff will be trained on the hazards associated with illegal discharges and improper disposal of waste and about the impact that stormwater discharges can have on local waterways, as well as the steps that the public can take to reduce pollutants in stormwater. This training is to occur annually throughout the term of the permit.
- b. **BMP – Revamp/improve website for easier access to stormwater information**
Goal – Staff will create a new page (linked from the main site: www.fernbluffmud.org) specific to stormwater pollution with the intent of making information readily available. The newly added content may very well be “borrowed” from internet sources that are also readily available. Website work should begin by the fall of 2019 and a functional page should be up and running by the end of the first quarter of 2020. Review and updates shall occur during the first quarter of each permit year.
- c. **BMP – Public education campaign on stormwater**
Goal – The District Staff is to create or borrow stormwater resources for posting on the District’s website and promote the postings biannually via water bill messaging, MailChimp and/or through the District’s mobile app.

2. Illicit Discharge Detection and Elimination (IDDE)

- a. **BMP** – Develop procedures for tracing and removing sources of illicit discharges.
Goal – By September 30, 2020, develop procedures for “Source Investigation and Elimination” in accordance with Part III.B.2.(c)(5), and Part III.B.3 of the General Permit.
- b. **BMP** - Staff training on identification and response to illicit discharges or connections.
Goal – On an annual basis starting year two, staff will be trained on the aspects of illicit discharge identification and response based on the procedures for “Source Investigation and Elimination”
- c. **BMP** - Identify illicit connections through dry weather screening inspection
Goal – Annually beginning year two, inspection of 25% of the storm sewer system will be conducted to identify non-stormwater flows.
- d. **BMP** – Review and update (if necessary) the MS4 map.
Goal – In conjunction with the annual inspections beginning year two, the MS4 map is to be reviewed for accuracy and updated if necessary.

3. Construction Site Stormwater Runoff Control

- a. **BMP** – Monitor construction activity within the District.
Goal – Not having any lots of greater than one acre (except for the parks and school) and being classified as a “Non-Traditional” MS4, the District will only monitor for construction activity. Should any unforeseen construction project surface, the District review and implement to the MEP the requirements set forth Part III.B.3(b)(1)-(7) of the General Permit.

4. Post Construction Stormwater Management in New Development and Redevelopment

- a. **BMP** – Monitor construction activity within the District.
Goal – Not having any lots of greater than one acre (except for the parks and school) and being classified as a “Non-Traditional” MS4, the District will only monitor for construction activity. Should any unforeseen construction project surface, the District review and implement to the MEP the requirements set forth Part III.B.4(b)(1)-(3) of the General Permit.

5. Pollution Prevention and Good Housekeeping for Municipal Operations

- a. **BMP** – Training program for maintenance and landscaping crews
Goal – Within 12 months (year one), develop and implement a pollution prevention training program for District staff and for the landscape subcontractor crews. Hold the training once per year for the duration of the permit.
- b. **BMP** – Sanitary sewer line cleaning and televising
Goal – By the end of year four of the permit, prepare a bid request for the cleaning and televising of the entire sanitary sewer system within the District.
- c. **BMP** – Review and update contractor agreements and contracts with requirements to comply with all the stormwater control measures and good housekeeping practices, and facility-specific stormwater management operating procedures.
Goal – During budget preparation season (June-August) of each year, management staff will review any contractor agreements and make any updates in accordance with the BMP as the contracts come up for renewal.

IV. Recordkeeping and Reporting

Section A. Recordkeeping

1. The District shall retain all records, a copy of this TPDES general permit, and records of all data used to complete the application (NOI) for this general permit and satisfy the public participation requirements, for a period of at least three (3) years, or for the remainder of the term of this general permit, whichever is longer. This period may be extended by request of the executive director at any time.
2. The District shall submit the records to the executive director only when specifically asked to do so. The SWMP required by this general permit (including a copy of the general permit) must be retained at a location accessible to the TCEQ.
3. The District shall make the NOI and the SWMP available to the public at reasonable times during regular business hours, if requested to do so in writing. Copies of the SWMP must be made available within ten (10) working days of receipt of a written request. Other records must be provided in accordance with the Texas Public Information Act. However, all requests for records from federal facilities must be made in accordance with the Freedom of Information Act.
4. The period during which records are required to be kept shall be automatically extended to the date of the final disposition of any administrative or judicial enforcement action that may be instituted against the permittee.

Section B. Reporting

1. General Reporting Requirements

(a) Noncompliance Notification

According to 30 TAC § 305.125(9), any noncompliance which may endanger human health or safety, or the environment, must be reported by the permittee to the TCEQ. Report of such information must be provided orally or by fax to the TCEQ Regional Office within 24 hours of becoming aware of the noncompliance. A written report must be provided by the permittee to the appropriate TCEQ Regional Office and to the TCEQ Enforcement Division (MC-224) within five working days of becoming aware of the noncompliance. The written report must contain:

- (1) A description of the noncompliance and its cause;
- (2) The potential danger to human health or safety, or the environment;
- (3) The period of noncompliance, including exact dates and times;
- (4) If the noncompliance has not been corrected, the anticipated time it is expected to continue; and
- (5) Steps taken or planned to reduce, eliminate, and prevent recurrence of the noncompliance, and to mitigate its adverse effects.

(b) Other Information

When the District becomes aware that it either submitted incorrect information or failed to submit complete and accurate information requested in an NOI, NOT, or NOC, or any other report, the permittee shall promptly submit the facts or information to the executive director.

2. Annual Report

The District shall submit a concise annual report to the executive director within 90 days of the end of each reporting year (Calendar Year was chosen by the District for reporting purposes). For the purpose of this section, the reporting year may include either the permit year, the permittee's fiscal year or the calendar year, as elected by the small MS4 and notified to the TCEQ in the application submittal. The annual report must address the previous reporting year. The first reporting year for annual reporting purposes shall begin on the permit effective date and shall last for a period of one (1) year (the end of the "permit year"). Alternatively, if the permittee elects to report based on its fiscal year, the first reporting year will last until the end of the fiscal year immediately following the issuance date of this permit. If the permittee elects to report based on the calendar year, then the first reporting year will last until December 31, 2019. Subsequent calendar years will begin at the beginning of the first reporting year (which will vary based on the previous paragraph) and last for one (1) year. The MS4 operator shall also make a copy of the annual report readily available for review by TCEQ personnel upon request. The report must include:

- (a) The status of the compliance with permit conditions, an assessment of the appropriateness of the identified BMPs, progress towards achieving the statutory goal of reducing the discharge of pollutants to the MEP, the measurable goals for each of the MCMs, and an evaluation of the success of the implementation of the measurable goals;
- (b) A summary of the results of information collected and analyzed, during the reporting period, including monitoring data used to assess the success of the program at reducing the discharge of pollutants to the MEP;
- (c) If applicable, a summary of any activities taken to address the discharge to impaired waterbodies, including any sampling results and a summary of the small MS4s BMPs used to address the pollutant of concern;
- (d) A summary of the stormwater activities the MS4 operator plans to undertake during the next reporting year;
- (e) Proposed changes to the SWMP, including changes to any BMPs or any identified measurable goals that apply to the program elements;
- (f) Description and schedule for implementation of additional BMP's that may be necessary, based on monitoring results, to ensure compliance with applicable TMDLs and implementation plans. For waters that are listed as impaired after discharge authorization pursuant to Part II.D.4, include a list of such waters and the pollutant(s) causing the impairment, and a summary of any actions taken to comply with the requirements of Part II.D.4.b.;

(g) Notice that the MS4 operator is relying on another government entity to satisfy some of its permit obligations (if applicable);

(h) The number of construction activities where the small MS4 is the operator and authorized under the 7th optional MCM, including the total number of acres disturbed; and

(i) The number of construction activities that occurred within the jurisdictional area of the small MS4 (as noticed to the permittee by the construction operator), and that were not authorized under the 7th MCM.

MS4s authorized under the previous version of the permit must prepare an annual report whether or not the NOI and SWMP have been approved by the TCEQ. If the permittee has either not implemented the SWMP or not begun to implement the SWMP because it has not received approval of the NOI and SWMP, then the annual report may include that information. If permittees share a common SWMP, they shall contribute to and submit a single systemwide report. Each permittee shall sign and certify the annual report in accordance with 30 TAC § 305.128 (relating to Signatories to Reports).

The annual report must be submitted with the appropriate TCEQ reporting forms if available, or as otherwise approved by TCEQ.

The annual report must be submitted to the following address:

Texas Commission on Environmental Quality

Stormwater Team; MC - 148

P.O. Box 13087

Austin, Texas 78711-3087

A copy of the annual report must also be submitted to the TCEQ Regional Office that serves the area of the regulated small MS4, except if the report is submitted electronically. Effective December 21, 2020, annual reports must be submitted using the online electronic reporting system available through the TCEQ website unless the permittee requests and obtains an electronic reporting waiver.

V. Schedule of Deliverables

Fern Bluff Municipal Utility District
Storm Water Management Program - Permit # TXR040625

Minimum Control Measures and their associated BMP Schedule of Deliverables

MCM	BMP	Due Date
1	Staff training on stormwater	Annually
1	Revamp/improve website for easier access to stormwater information	3/31/2020 with review and updates by 3/31 of each permit year
1	Public education campaign on stormwater	Biannually - Spring and Fall
2	Develop procedures for tracing and removing sources of illicit discharges	9/30/2020
2	Staff training on identification and response to illicit discharges or connections	by 12/31/2020 and every permit year thereafter
2	Identify illicit connections through dry weather screening inspection	by 12/31/2020 and every permit year thereafter
2	Review and update (if necessary) the MS4 map	by 12/31/2020 and every permit year thereafter
5	Training program for maintenance and landscaping crews	by 12/31/2020 and every permit year thereafter
5	Sanitary sewer line cleaning and televising	12/31/2022
5	Review and update contractor agreements and contracts with requirements to comply with all the stormwater control measures and good housekeeping practices, and facility-specific stormwater management operating procedures.	Annually during month of August

VI. Map

A reduced size of the system map is included in the next page but is also available at the main office and electronically in the "MUD Documents" folder located on the NAS drive.

FERN BLUFF MUNICIPAL UTILITY DISTRICT
 MSI STORM SEWER MAP

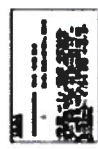
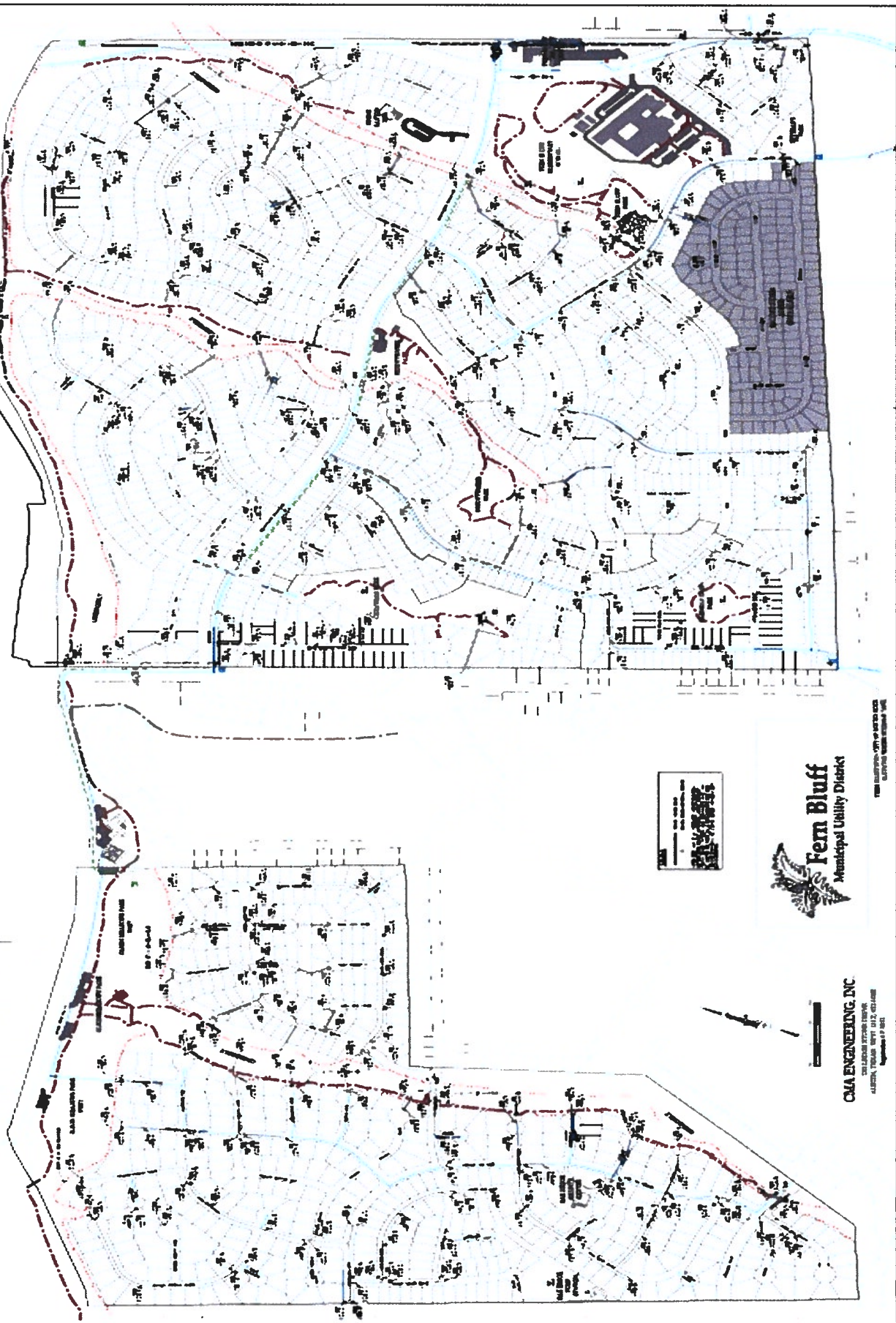

CMA ENGINEERING, INC.
 1400 WEST 10TH STREET
 AUSTIN, TEXAS 78703
 REGISTERED PROFESSIONAL ENGINEERS

THIS MAP WAS PREPARED BY
 CMA ENGINEERING, INC.